

APPLICATION CHECKLIST

Trumbull County, Vienna Twp.

Kleese # 5 SWIW # 25

	Date	Initials
Enter on Agenda	7-9-12	AA
Completeness Review	7-9-12	AA
Date - Time Stamp	7-3-12	AA
Area of Review	7-9-12	AA
Site Evaluation	8-9-12	AA
Permitting Section		
Memo to Inspector	7-25-12	AA
Public Notice	8-1-12	AA
Letter		
Date Run		
15 Days		
Review Public Notice		
Affidavit of Notification		
Objections Received	Yes _____ No _____	
Public Hearing Date		
Chief's Order, if Required		
Schematic	7/10/12	AA
Plot on Map	7-10-12	AA
Review by Geologist		
Permit Conditions (Same date as permit)		
Enter on Computer (Same or later date than Chief's Order)		
Enter on Master List	7-9-12	AA
EPA Form	7-9-12	AA
Mail Permit		
Update Agenda		
File		

RECORD OF CONVERSATION

-Needs surface facility sketch

-Will use existing - 7-26-12

DAILY ROUTE SLIP

Vienna

APPLICATION NO. aAMY0001282 TYPE: Convert SWIW
CONAME KLEESE DEVELOPMENT ASS API 34155237590000
WELL NAME /NO. KLEESE 5

COUNTY 155 TRUMBULL INITIALS DATE

DATE APPLICATION REC'D *[Signature]* 7/3/2012

PERMIT FEE AND CHECK NO. \$1,000.00 14528

RUSH AMOUNT RUSH CHECK NO. \$0.00 0

APPLICATION ENTERED *[Signature]* 7/3/2012

APPLICATIONS AND PLATS SENT FOR MINE APPROVAL NA 7-23-12

COAL APPROVAL RECEIVED NA 7-23-12

OIL/GAS AFFIDAVIT REC'D _____

URBANIZED AREA NOTIFICATION SENT _____

URBANIZED AREA NOTIFICATION SENT TO INSPECTOR/REC'D BACK _____

URBAN MAP REVIEW _____

SAMPLES: YES _____ /SPECIAL AREAS _____

GEOLOGIST APPROVAL _____

DATA ENTRY /ISSUED _____

PERMIT: TAKEN _____ MAILED _____

FAX TO: _____

FINAL MAP CHECK _____

COMMENTS: _____

Proof Sheet

APPL NUMBER

OWNER NUMBER

OWNER NAME

EXISTING WELL

API PERMIT NO

APPL TYPE

TYPE OF WELL

VARIANCE REQUEST

WELL NAME

WELL NUMBER

PREV/PROPOSED TD

DRILL UNIT ACRES

TYPE OF TOOL

WELL CLASS

FIRE PHONE

MEDICAL PHONE

COUNTY CODE

COUNTY NAME

COAL (Y=-1/N=0)

CIVIL TOWNSHIP

SURF QUAD

Nad 27 SURF ORIG X

Nad 27 SURF ORIG Y

GROUND ELEVATION

SURF SEC

SURF LOT

SURF QTR TWP

SURF ALLOT

SURF TRACT

SURF FRACTION

URBANIZED AREA ?

NAME

DISPOSAL PLAN 1

DISPOSAL PLAN 2

DISPOSAL PLAN 3

DISPOSAL PLAN 4

DISPOSAL PLAN 5

MP Check #

PROPOSED FORMATIONS

CLINTON

TARG CIVIL TWP

TARG QUAD

Nad 27 TARG ORIG X

Nad 27 TARG ORIG Y

TARG ELEV

TARG SECTION

TARG LOT

TARG QTR TWP

TARG ALLOT

TARG TRACT

TARG FRACTION

Ohio Department of Natural Resources
Division of Oil and Gas Resources Management
Facility Report

API Well No.

34155237590000

Project:

County: TRUMBULL Twp VIENNA Sec: 0 Lot: 0 WI Typ: OG

Owner KLEESE DEVELOPMENT ASSOCS Resp Co

Well Name: KLEESE 5 No.: WH_LAT 0.000000 WH_LONG: 0.000000

Directions to site: Sodom-hutchins road north of Warren-sharon road on west side .

Inspection Type: Salt Water Injection Well Contact: Phone
Address

Inspection Purpose: Request

Type of Notification Contact STEPHEN OCHS

Inspection Comments:

The well owner has applied to convert the well from production to saltwater injection. The well site was inspected as part of a field review. There are no houses within 1000 feet of the well. The lease access road will remain unchanged. The existing injection well surface facility will be used. Nothing found would warrant additional permit conditions.

Accompanied by

INJECTIONPRESSUR Vac ANNULUSPRESSURE: Vac FLOWMETER: Vac

HAULERNO: LISCENSE_NUM:

LANDOWNERWAIVER: P_REST_PASS: F_REST_PASS:

Inspection Date: 7/30/2012

Signature:

Date notice of violation Issued:

STEPHEN OCHS

Required action to be completed by:

Reviewed by:

Extended action due:

Forward to:

Required action completed: 7/30/2012

Duration: _____ hrs

RECEIVED

AUG 09 2012

Division of Oil and Gas
Resources Management

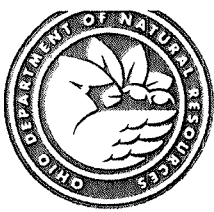

Ohio Department of Natural Resources

JOHN R. KASICH, GOVERNOR

JAMES ZEHRINGER, DIRECTOR

Richard J. Simmers, Chief
Division of Oil and Gas Resources Management
2045 Morse Road, Bldg. F-2
Columbus, OH 43229-6693
Phone (614) 265-6922 Fax (614) 265-6910

August 1, 2012

Mr. Robert S. Kleese
Kleese Development Associates, Inc.
103 West Market
Warren, Ohio 44481

RE: Public Notification for SWIW application for Trumbull County, Vienna Twp., Permit #3732 and #3759, Kleese Development Associates, Inc., Kleese SWD #4 and #5 injection wells

Dear Mr. Barnett:

As outlined in Rule 1501: 9-3-06 (H) (1) of the Ohio Administrative Code, please consider this letter as notification from the Division for you to proceed with the public notice. Enclosed, please find a copy of the notice you will need to have run in the newspaper of general circulation in the area of the proposed injection well. **The public notice must be run for no less than five consecutive days. After running this notice in the newspaper, please send me the original proof-of-publication from the newspaper as soon as possible.**

If you have any questions regarding this matter, please feel free to contact me at (614) 265-6673.

Sincerely,

A handwritten signature in black ink, appearing to read "A. Adgate".

Andrew Adgate, Geologist
UIC Section
Division of Oil and Gas Resources Management
2045 Morse Road, F-2
Columbus, Ohio 43229-6693

Cc: File

PUBLIC NOTICE

Kleese Development Associates, Inc., 103 West Market, Warren, Ohio 44481, (330) 392-7899 is applying to permit two wells for the injection of brine water produced in association with oil and natural gas. The location of the proposed injection wells, the Kleese #4 and #5, Permit #3732 and #3759, Section 10, Vienna Township, Trumbull County, Ohio. The proposed wells will inject into the Clinton formation at a depth of 4940 to 5078 feet and 4885 to 5033 feet. The average injection is estimated to be 500 barrels per day. The maximum injection pressure is estimated to be 1140 and 1125 psi. Further information can be obtained by contacting Kleese Development Associates, Inc., or the Division of Oil and Gas Resources Management. The address of the Division is: Ohio Department of Natural Resources, Division of Oil and Gas Resources Management, 2045 Morse Road, Building F-2, Columbus, Ohio 43229-6693, (614) 265-6633. For full consideration, all comments and objections must be received by the Division, in writing, within fifteen calendar days of the last date of this published legal notice.

Trumbull County, Vienna Twp.
 Kleese #5 SW1W#25

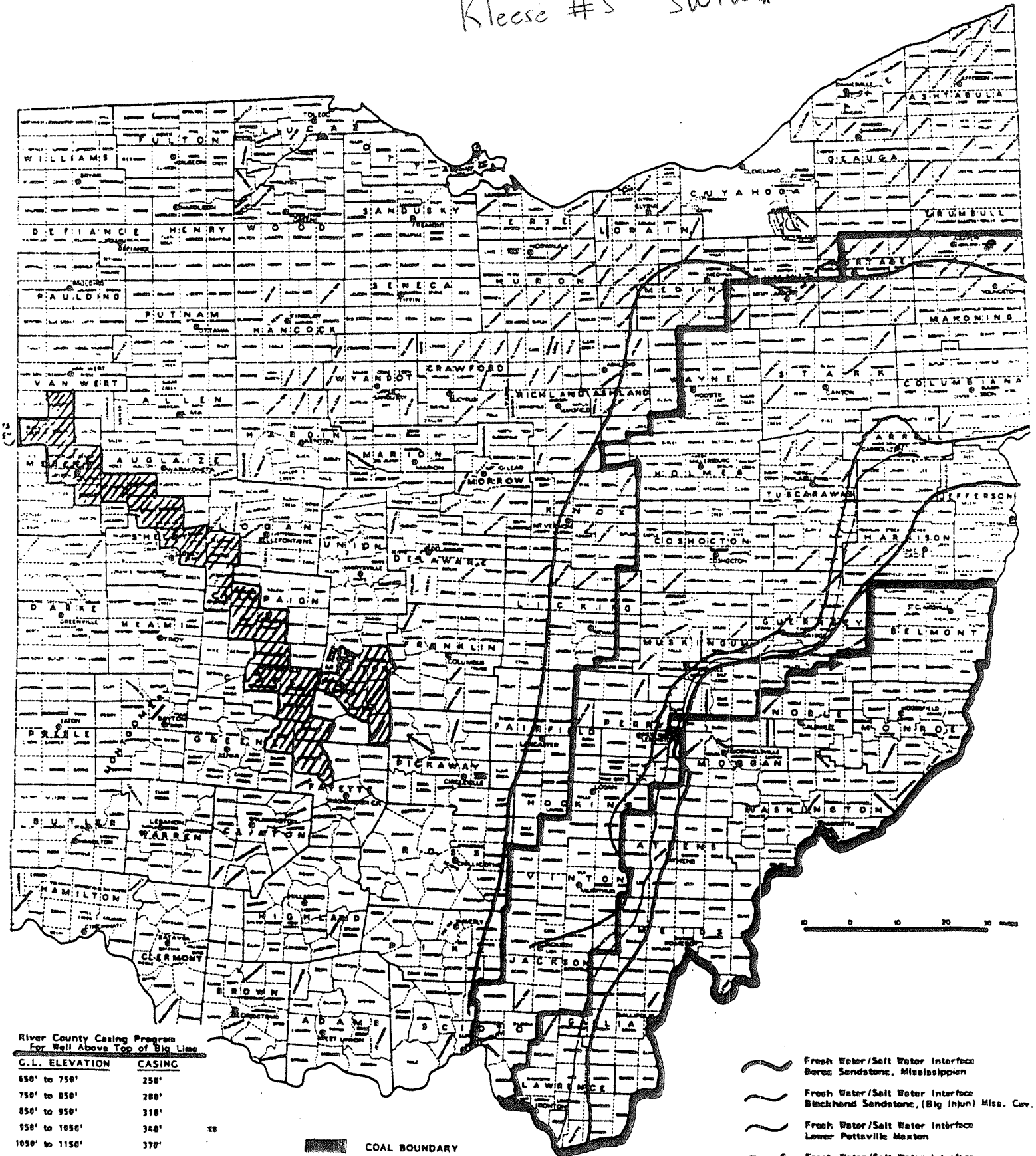

River County Casing Program
 For Well Above Top of Big Lick

G.L. ELEVATION	CASING
650' to 750'	250'
750' to 850'	280'
850' to 950'	310'
950' to 1050'	340'
1050' to 1150'	370'
1150' to 1250'	400'
1250' to 1350'	430'
OVER 1350'	500'

COAL BOUNDARY

- ~~~~~ Fresh Water/Salt Water Interface
Berea Sandstone, Mississippian
- ~~~~~ Fresh Water/Salt Water Interface
Blackhand Sandstone, (Big Injun) Miss. Conv.
- ~~~~~ Fresh Water/Salt Water Interface
Lower Pottsville Maxton
- ~~~~~ Fresh Water/Salt Water Interface
Upper Allegheny 2nd Coe Run

P & A	FM	Permit Number	Casing Program / Comment	Well Log and/or Method of Plug
<input type="checkbox"/>	<u>Nbg</u>	<u>1606</u>	<u>8 5/8" - 490' - cemented to surface</u>	<u>Proposed depth = 4532' - 9"</u>
			<u>4 1/2" - 5078' - cemented w/125 sks.</u>	
			<u>Calculated fill-up = 697' - TDC = 4431'</u>	
<input type="checkbox"/>	<u>CL</u>	<u>3759</u>	<u>8 5/8" - 586' - cemented to surface</u>	
			<u>4 1/2" - 5059' - cemented w/150 sks, Calculated</u>	
			<u>fill-up = 777' TDC = 4281'</u>	
<input type="checkbox"/>	<u>CL</u>	<u>1447</u>	<u>8 5/8" - 569' - cemented to surface</u>	
			<u>4 1/2" - 5146' - cemented w/125 sks. 50/50 Por 10% salt</u>	
			<u>Calculated fill-up = 708 TDC = 4438'</u>	
<input type="checkbox"/>	<u>CL</u>	<u>2396</u>	<u>8 5/8" - 550' - cemented w/200 sks.</u>	
			<u>4 1/2" - 5109' - cemented w/150 sks. 50/50 Por</u>	
			<u>Calculated fill-up = 830' TDC = 4278'</u>	
<input type="checkbox"/>	<u>CL</u>	<u>2788</u>	<u>8 5/8" - 479' - cemented to surface</u>	
			<u>4 1/2" - 5070' - cemented w/150 sks. Calculated</u>	
			<u>fill-up = 777' TDC = 4293'</u>	
<input type="checkbox"/>	<u>CL</u>	<u>1313</u>	<u>8 5/8" - 482' - cemented to surface</u>	
			<u>4 1/2" - 5154' - cemented w/150 sks. Calculated</u>	
			<u>fill-up = 777' TDC = 4377'</u>	
<input type="checkbox"/>	<u>CL</u>	<u>1223</u>	<u>8 5/8" - 513' - cemented to surface</u>	
			<u>4 1/2" - 5115' - cemented w/150 sks. Calculated</u>	
			<u>fill-up = 777' TDC = 4338'</u>	
<input type="checkbox"/>	<u>CL</u>	<u>2395</u>	<u>8 5/8" - 536' - cemented to surface</u>	
			<u>4 1/2" - 5072' - cemented w/150 sks. Calculated</u>	
			<u>fill-up = 777' TDC = 4295'</u>	

NOTE: Proposed injection well should be circumscribed with appropriate radius and all wells clearly labeled and identified. A legend depicting color code is required.

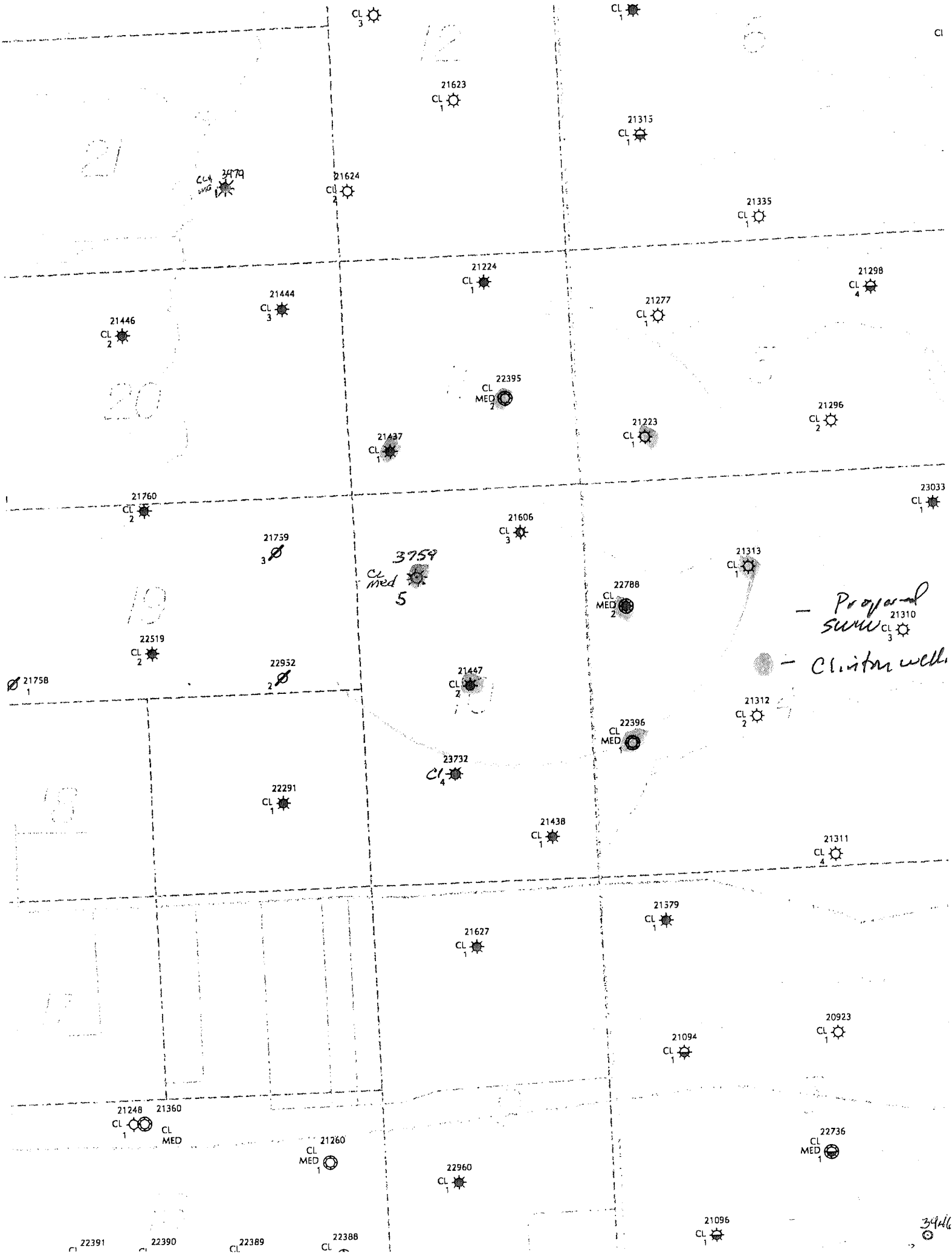

- Proposed SWW
- Clinton well

3446

21

12

20

19

18

17

21623
CL 1

21315
CL 1

21624
CL 2

21335
CL 1

21779
CL 1

21224
CL 1

21298
CL 4

21446
CL 2

21444
CL 3

21277
CL 1

22395
CL MED 2

21296
CL 2

21437
CL 1

21223
CL 1

21760
CL 2

23033
CL 1

21759
3

21606
CL 3

3759
CL Med 5

21313
CL 1

22519
CL 2

22788
CL MED 2

21758
1

22952
2

21447
CL 2

21312
CL 2

22396
CL MED 1

23732
CL 4

22291
CL 1

21438
CL 1

21311
CL 4

21627
CL 1

21579
CL 1

20923
CL 1

21094
CL 1

21248
CL 1

21360
CL MED

21260
CL MED 1

22736
CL MED 1

22960
CL 1

21096
CL 1

22391

22390

22389

22388

INTER-OFFICE MEMO

TO: Steve Ochs, Mineral Resources Inspector
FROM: Andrew Adgate, Geologist AA
SUBJECT: Application and Site Evaluation for a SWIW permit
DATE: July 25, 2012

The Division of Oil and Gas Resources Management has received an application for the proposed saltwater injection well as described below:

OPERATOR: Kleese Development Assoc.
WELL NAME & NUMBER: Kleese #5
PERMIT NUMBER: Conversion of existing well, SWIW #25
LOCATION: 997' NL & 685' WL of Lot 10, Vienna Twp., Trumbull County
PROPOSED INJECTION ZONE: Clinton group
DATE RECEIVED: July 3, 2012

Please inspect proposed site and evaluate for any potential water wells or surface bodies of water within close proximity that would require any additional permit conditions for the construction of the SWIW surface facilities. Please e-mail me a copy of the site inspection report with any recommendations.

APPLICATION FOR A PERMIT (Form 1)
 OHIO DEPARTMENT OF NATURAL RESOURCES
 DIVISION OF MINERAL RESOURCES MANAGEMENT
 2045 Morse Road, Building H-3
 COLUMBUS, OHIO 43229-6693
 (614) 265-6633

#14528
 \$1,000.00

2000001282

SEE INSTRUCTIONS ON PAGE 2 (BACK)

1. I, We (applicant) KLEESE DEVELOPMENT ASSOC. 2. Owner #: 2655
 (address) 103 West Market St. Phone #: 330-392-7899
Third Floor
 hereby apply this date Warren, OH 44481 for a permit to:

Reissue (check appropriate blank) Revised Location Convert
 Drill New Well Plug Back Deepen
 Drill Directionally Plug and Abandon Reopen
 Drill Horizontally Orphan Well Program Temporary Inactive

3. TYPE OF WELL: Oil & Gas Annular Disposal Saltwater Injection
 Stratigraphic Test Gas Storage Other (explain): _____
 Solution Mining* Enhanced Recovery* (* if checked, select appropriate box below)
 Input/Injection Water Supply Observation Production/Extraction

4. MAIL PERMIT TO: Same

5. COUNTY: Trumbull

6. CIVIL TOWNSHIP: VIENNA

7. SECTION: 10 8. LOT: _____

9. FRACTION: _____ 10. QTR TWP: _____

11. TRACT / ALLOT: _____

12. WELL #: 5

13. LEASE NAME: KLEESE

14. PROPOSED TOTAL DEPTH: _____

15. PROPOSED GEOLOGICAL FORMATION: _____

16. DRILLING UNIT IN ACRES (must be same as acres indicated on plat): _____

17. IF PERMITTED PREVIOUSLY:
 API #: 34-1352-3739-00-00
 OWNER: KLEESE
 WELL #: 5
 LEASE NAME: KLEESE
 TOTAL DEPTH: 5101
 GEOLOGICAL FORMATION: Clinton

18. IF SURFACE RIGHTS ARE OWNED BY THE OHIO DEPARTMENT OF NATURAL RESOURCES
 Division Name: _____
 Division Phone: _____

19. LANDOWNER ROYALTY INTEREST:
 Is There An Attached List? Yes No
 Name: Robert S. Kleese
 Address: 103 West Market, Warren OH 44481
 Name: Jane Kleese
 Address: same
 Name: Edward Kleese
 Address: same

20. TYPE OF TOOLS:
 Cable Air Rotary
 Cable / Air Rotary Air / Fluid Rotary
 Cable / Fluid Rotary Fluid Rotary
 Cable / Air / Fluid Rotary Service Rig

21. PROPOSED CASING PROGRAM:
See supplement to application

22. FIRE AND MEDICAL DEPARTMENT TELEPHONE NUMBERS: (closest to well site)
 Fire: 911
 Medical: 911

23. MEANS OF INGRESS & EGRESS:
 Township Road: Sodom Hills Rd
 County Road: _____
 Municipal Road: _____
 State Highway: _____

24. IS THE WELL LOCATION OR PRODUCTION FACILITIES WITHIN AN URBANIZED AREA AS DEFINED BY 1509.01(Y)
 Yes No

RECEIVED

JUL 28 2012

I, the undersigned, being first duly sworn, depose and state under penalties of law, that I am authorized to make this application, that this application was prepared by me or under supervision and direction, and that the facts stated herein are true, correct, and complete, to the best of my knowledge.

I, the undersigned, further depose and state that I am the person who has the right to drill on the tract or drilling unit and to drill into and produce from a pool and to appropriate the oil or gas that I produce therefrom either for myself or others as described in this application. And furthermore, I the undersigned, being duly sworn, depose and state at this time that I am not liable for any final nonappealable order of a court for damage to streets, roads, highways, bridges, culverts, or drainage ways pursuant to Section 5577.12 of the Ohio Revised Code (ORC). I, the undersigned, further depose and state that all notices required by 1509.06 (A) (9) ORC for this application have been duly provided by me. If applying for a permit to plug and abandon a well, I hereby certify that the written notices, as required in Section 1509.13, ORC, have been given.

That I hereby agree to conform with all provisions of Chapter 1509., ORC, and Chapter 1501., OAC, and all orders and conditions issued by the Chief, Division of Mineral Resources Management.

Signature of Owner/Authorized Agent [Signature]
 Name (Type or Print) Robert S. Kleese Title Partner

If signed by Authorized Agent, a certificate of appointment of agent must be on file.

Sworn to and subscribed before me this the 29 day of June, 2012

[Signature]
 (Notary Public)

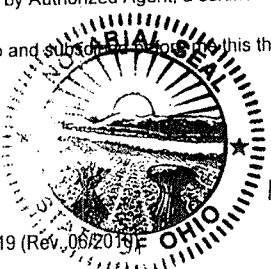

LAURA A EASTON
 NOTARY PUBLIC - OHIO
 MY COMMISSION EXPIRES 4-17-2017

4-17-2017
 (Date Commission Expires)

original #5

SUPPLEMENT TO APPLICATION PERMIT FOR A SALTWATER INJECTION WELL

Form 210: rev. 8/00/sly

AREA OF REVIEW. An application for a saltwater injection well (SWIW) will be evaluated on the basis of an "area of review" surrounding the proposed well. The area of review for wells in which injection of greater than two hundred barrels per day is proposed shall be the area circumscribed by a circle with the center point at the location of the injection well and a radius of one-half mile. The area of review for wells in which a maximum injection of two hundred barrels per day or less is proposed shall be the area circumscribed by a circle with the center point at the location of the injection well and a radius of one-quarter mile.

31. PROPOSED INJECTION ZONE

Geological Formation: Clinton Group feet to 5033
Injection Interval: From: 4825
Geologic description of injection zone: Clinton Group

32. WELL CONSTRUCTION AND OPERATION

A. Description of the proposed casing and cement program for new wells, or of the casing, cementing or sealing with prepared clay for existing wells to be converted: existing Clinton Well

11 3/4" - NONS
8 3/8" - 522 FT - Cemented to surface
4 1/2" - 5058 FT - see cement bond log

B. Proposed method for testing the casing: SAME as Kleese #4

C. Description of the proposed method for completion and operation of the injection well: Perforate Clinton
2 shots - Gashoto etc / FT. reach 20', 3000 GAL 20% HCL + FEAL 3000
minimum, 5000 bbl max

D. Description of the proposed unloading, surface storage, and spill containment facilities: Kleese #5 &
it will be sharing same unloading & pump facility as the state
operated & approved Kleese 122

RECEIVED

JUL 08 2012

33. PROPOSED INJECTION VOLUMES

A. Indicate the estimated amount of saltwater to be injected into the proposed injection well per day:

AVERAGE: 500 bbl MAXIMUM: 1200 bbl

B. Indicate the method to be used to measure the actual amount of saltwater injected into the well:

Mechanically measured

34. PROPOSED INJECTION PRESSURES

A. Indicate the estimated pressure to be used for injection of saltwater into the proposed injection well:

AVERAGE: 500 PSI MAXIMUM: states limit set on well

B. Indicate the method to be used to measure the actual daily injection pressure:

Murphy switch Reading of Well Head Reading

35. PROPOSED CORRECTIVE ACTION

Explain any corrective action proposed for wells penetrating the proposed injection formation or zone within the area of review.

Keep an adequate daily pressure on well to minimize
chance of communication w/ other gas wells. Kleese production
on a gas well. If communication of injection zone is reached
accordance, plug & abandon if necessary. Due to the state
surrounding production being mostly Kleese developments

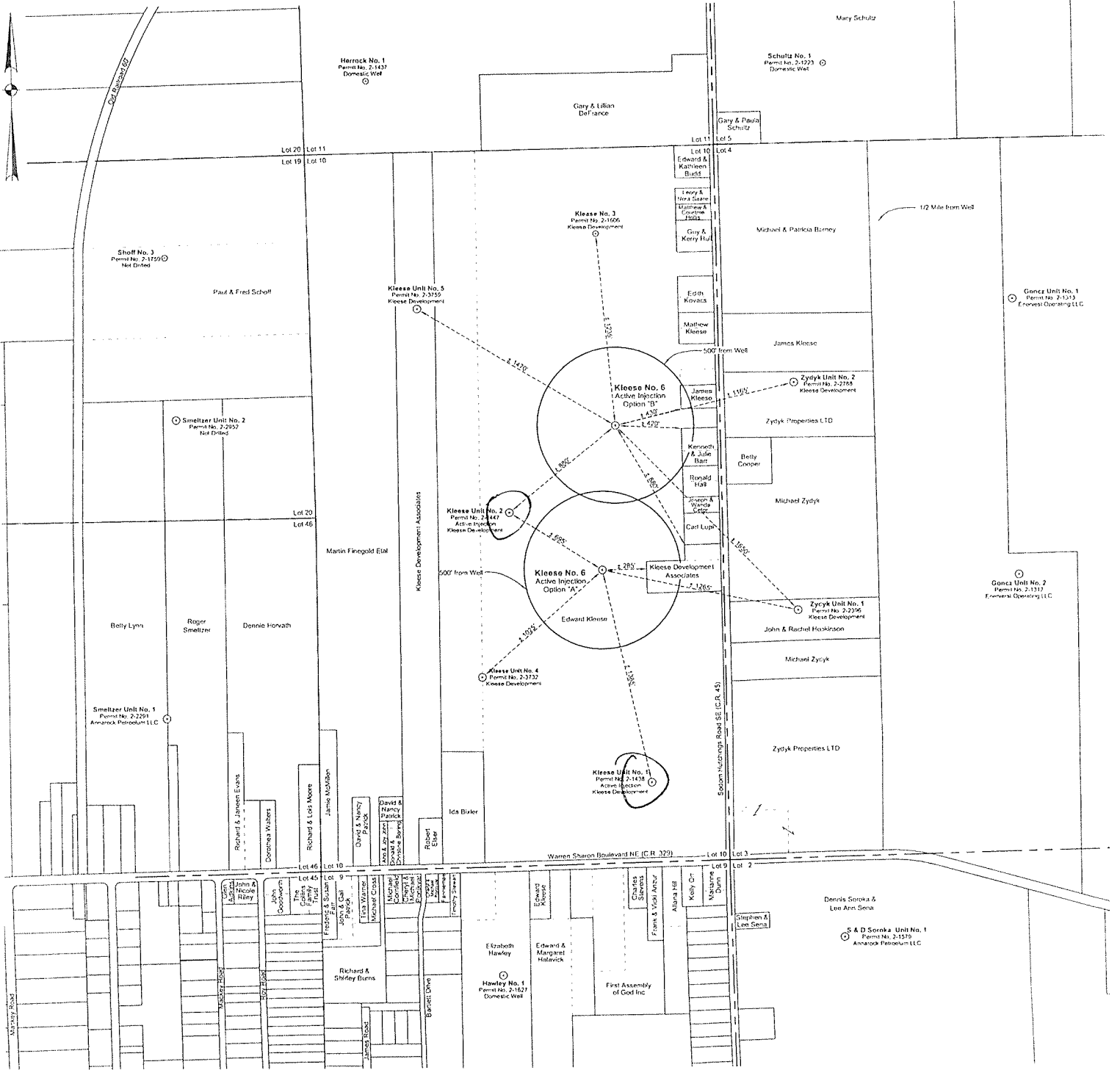

Operator: Kleese Development Associates
 Address: 103 W. Market St., Warren, Ohio, 44481
 Job Name: CCWD Meter Tap



David Bodo & Associates, Inc.
 Professional Surveyors
 5175 Tonga Rd NW, Carrollton, Ohio, 44615
 (330) 863-7300 KDA 2174

APPLICATION FOR A PERMIT (Form 1)
 OHIO DEPARTMENT OF NATURAL RESOURCES
 DIVISION OF MINERAL RESOURCES MANAGEMENT
 2045 Morse Road, Building H-3
 COLUMBUS, OHIO 43229-6693
 (614) 265-6633

SEE INSTRUCTIONS ON PAGE 2 (BACK)

1. I, We (applicant) KLEESE DEVELOPMENT ASSOC. 2. Owner #: 2655
 (address) 103 West Market St. Phone #: 330-392-7899
Third Floor
 hereby apply this date Warren, OH 44482 for a permit to:

- | | | |
|--|--|---|
| <input type="checkbox"/> Reissue (check appropriate blank) | <input type="checkbox"/> Revised Location | <input checked="" type="checkbox"/> Convert |
| <input type="checkbox"/> Drill New Well | <input type="checkbox"/> Plug Back | <input type="checkbox"/> Deepen |
| <input type="checkbox"/> Drill Directionally | <input type="checkbox"/> Plug and Abandon | <input type="checkbox"/> Reopen |
| <input type="checkbox"/> Drill Horizontally | <input type="checkbox"/> Orphan Well Program | <input type="checkbox"/> Temporary Inactive |

3. TYPE OF WELL: Oil & Gas Annular Disposal Saltwater Injection
 Stratigraphic Test Gas Storage Other (explain): _____
 Solution Mining* Enhanced Recovery* (* if checked, select appropriate box below)
 Input/Injection Water Supply Observation Production/Extraction

4. MAIL PERMIT TO: Same
 20. TYPE OF TOOLS: Cable Air Rotary
 Cable / Air Rotary Air / Fluid Rotary
 Cable / Fluid Rotary Fluid Rotary
 Cable / Air / Fluid Rotary Service Rig

5. COUNTY: Trumbull
 6. CIVIL TOWNSHIP: VIENNA
 7. SECTION: 10 8. LOT: _____
 9. FRACTION: _____ 10. QTR TWP: _____
 11. TRACT / ALLOT: _____
 12. WELL #: 5
 13. LEASE NAME: KLEESE
 14. PROPOSED TOTAL DEPTH: _____
 15. PROPOSED GEOLOGICAL FORMATION: _____
 16. DRILLING UNIT IN ACRES (must be same as acres indicated on plat): _____
 17. IF PERMITTED PREVIOUSLY:
 API #: 34-1552-3759-00-00
 OWNER: KLEESE
 WELL #: 5
 LEASE NAME: KLEESE
 TOTAL DEPTH: 5101
 GEOLOGICAL FORMATION: (Minton)
 18. IF SURFACE RIGHTS ARE OWNED BY THE OHIO DEPARTMENT OF NATURAL RESOURCES
 Division Name: _____
 Division Phone: _____

21. PROPOSED CASING PROGRAM:
See supplement to application

22. FIRE AND MEDICAL DEPARTMENT TELEPHONE NUMBERS: (closest to well site)
 Fire: 911
 Medical: 911

23. MEANS OF INGRESS & EGRESS:
 Township Road: Sodom Hutchings
 County Road: _____
 Municipal Road: _____
 State Highway: _____

24. IS THE WELL LOCATION OR PRODUCTION FACILITIES WITHIN AN URBANIZED AREA AS DEFINED BY 1509.01?
 Yes No

19. LANDOWNER ROYALTY INTEREST:
 Is There An Attached List? Yes No
 Name: Robert S. Kleese
 Address: 103 West Market, Warren OH 44481
 Name: James Kleese
 Address: same
 Name: Edward Kleese
 Address: same

RECEIVED
 JUL 10 2012

I, the undersigned, being first duly sworn, depose and state under penalties of law, that I am authorized to make this application, that this application was prepared by me or under supervision and direction, and that the facts stated herein are true, correct, and complete, to the best of my knowledge.
 I, the undersigned, further depose and state that I am the person who has the right to drill on the tract or drilling unit and to drill into and produce from a pool and to appropriate oil or gas that I produce therefrom either for myself or others as described in this application. And furthermore, I the undersigned, being duly sworn, depose and state at this time that I am not liable for any final nonappealable order of a court for damage to streets, roads, highways, bridges, culverts, or drainage ways pursuant to Section 5577.12 of the Ohio Revised Code (ORC). I, the undersigned, further depose and state that all notices required by 1509.06 (A) (9) ORC for this application have been duly provided by me. If applying for a permit to plug and abandon a well, I hereby certify that the written notices, as required in Section 1509.13, ORC, have been given.
 That I hereby agree to conform with all provisions of Chapter 1509., ORC, and Chapter 1501., OAC, and all orders and conditions issued by the Chief, Division of Mineral Resources Management.

Signature of Owner/Authorized Agent [Signature]
 Name (Type or Print) Robert S. Kleese Title Partner

If signed by Authorized Agent, a certificate of appointment of agent must be on file.
 Sworn to and subscribed before me this the 29 day of June, 2012.

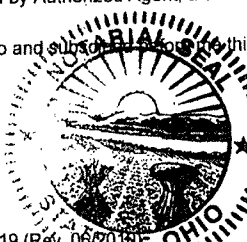
 LAURA A EASTON
 NOTARY PUBLIC - OHIO
 MY COMMISSION EXPIRES 4-17-2017
[Signature]
 (Notary Public)
4-17-2017
 (Date Commission Expires)

original #5

SUPPLEMENT TO APPLICATION PERMIT FOR A SALTWATER INJECTION WELL

Form 210: rev. 8/0

AREA OF REVIEW. An application for a saltwater injection well (SWIW) will be evaluated on the basis of an "area of review surrounding the proposed well. The area of review for wells in which injection of greater than two hundred barrels per day is proposed shall be the area circumscribed by a circle with the center point at the location of the injection well and a radius of one-half mile. The area of review for wells in which a maximum injection of two hundred barrels per day or less is proposed shall be the area circumscribed by a circle with the center point at the location of the injection well and a radius of one-quarter mile.

31. PROPOSED INJECTION ZONE

Geological Formation: Clinton Group feet to 5033
Injection Interval: From: 4885
Geologic description of injection zone: Clinton Group

32. WELL CONSTRUCTION AND OPERATION

- A. Description of the proposed casing and cement program for new wells, or of the casing, cementing or sealing with prepared clay for existing wells to be converted: Existing Clinton Well
11 3/4" - NONS
8 1/8" - 322 FT - CEMENTED TO SURFACE
4 1/2" - 5058 FT - SEE CEMENT BAND LOG
- B. Proposed method for testing the casing: SAME AS KLEESE #4
- C. Description of the proposed method for completion and operation of the injection well: Perforate Clinton
shots - 1 shot etc / FT, acid 2%, 3000 Gal 2% HCl + REAG 3
minimum, 5000 bbl Max
- D. Description of the proposed unloading, surface storage, and spill containment facilities: Kleese #5 &
It will be sharing same unloading & pump facility as the site
operated & approved Kleese 122

RECEIVED

JUL 03 2012

33. PROPOSED INJECTION VOLUMES

- A. Indicate the estimated amount of saltwater to be injected into the proposed injection well per day:
 AVERAGE: 500 bbl MAXIMUM: 1200 bbl
- B. Indicate the method to be used to measure the actual amount of saltwater injected into the well:
Mechanically measured

34. PROPOSED INJECTION PRESSURES

- A. Indicate the estimated pressure to be used for injection of saltwater into the proposed injection well: 1125 psi
 AVERAGE: 500 psi MAXIMUM: States limit set on it
- B. Indicate the method to be used to measure the actual daily injection pressure:
Murphy switch Reading & Well Head Reading

35. PROPOSED CORRECTIVE ACTION

Explain any corrective action proposed for wells penetrating the proposed injection formation or zone within the area review.
Keep an average daily pressure on well to minimize
chance of communication with other gas wells. Kleese production
surrounding zone. If communication or injection zone is reached
on a gas well, plug & abandon if necessary w/ in the state
accordance, however preliminary review shows. Due to
surrounding production being mostly Kleese development

Trumbull County, Vienna Twp., SWIW # 25
Kleese # 5

**Subsurface Construction
For Injection Well**

Maximum Injection Pressure: 1125 psi

Injection

**8 5/8" Surf csg set
at 582' & cmtd to
surface**

**4 1/2" Prod csg set
at 5058' & cmtd
back to 4348'**

**1 1/2" Tubing set @4818'
at approx 69'
above injection zone**

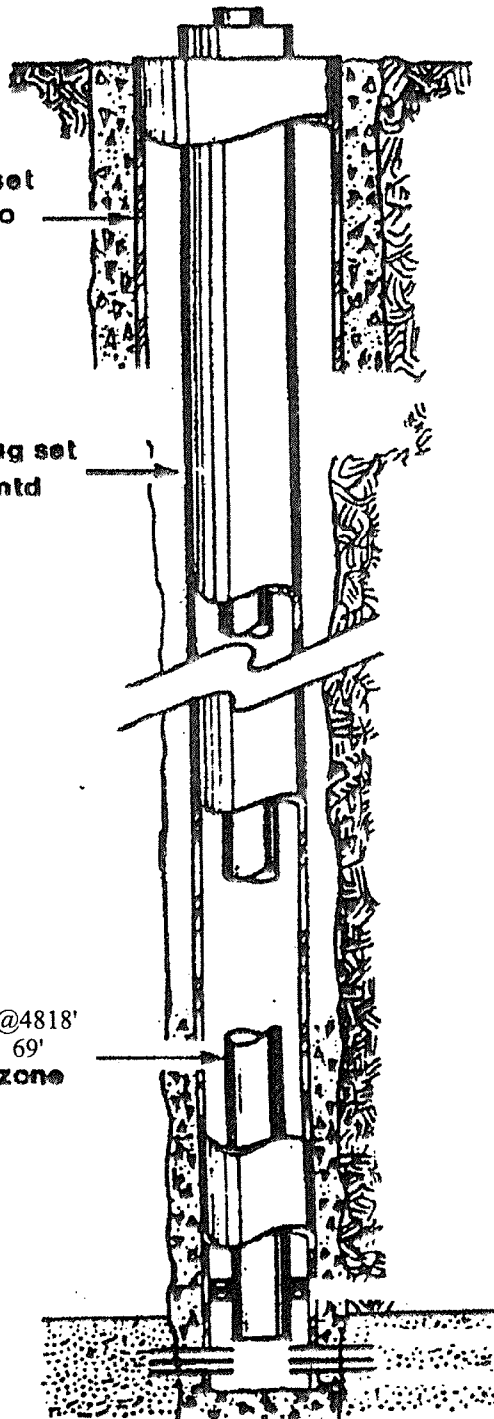

Clinton Formation
4885' - 5033'

Total Depth: 5101'

Trumbull County, Vienna Twp., SWIW # 25
Kleese # 5

**Subsurface Construction
For Injection Well**

Maximum Injection Pressure: 1125 psi

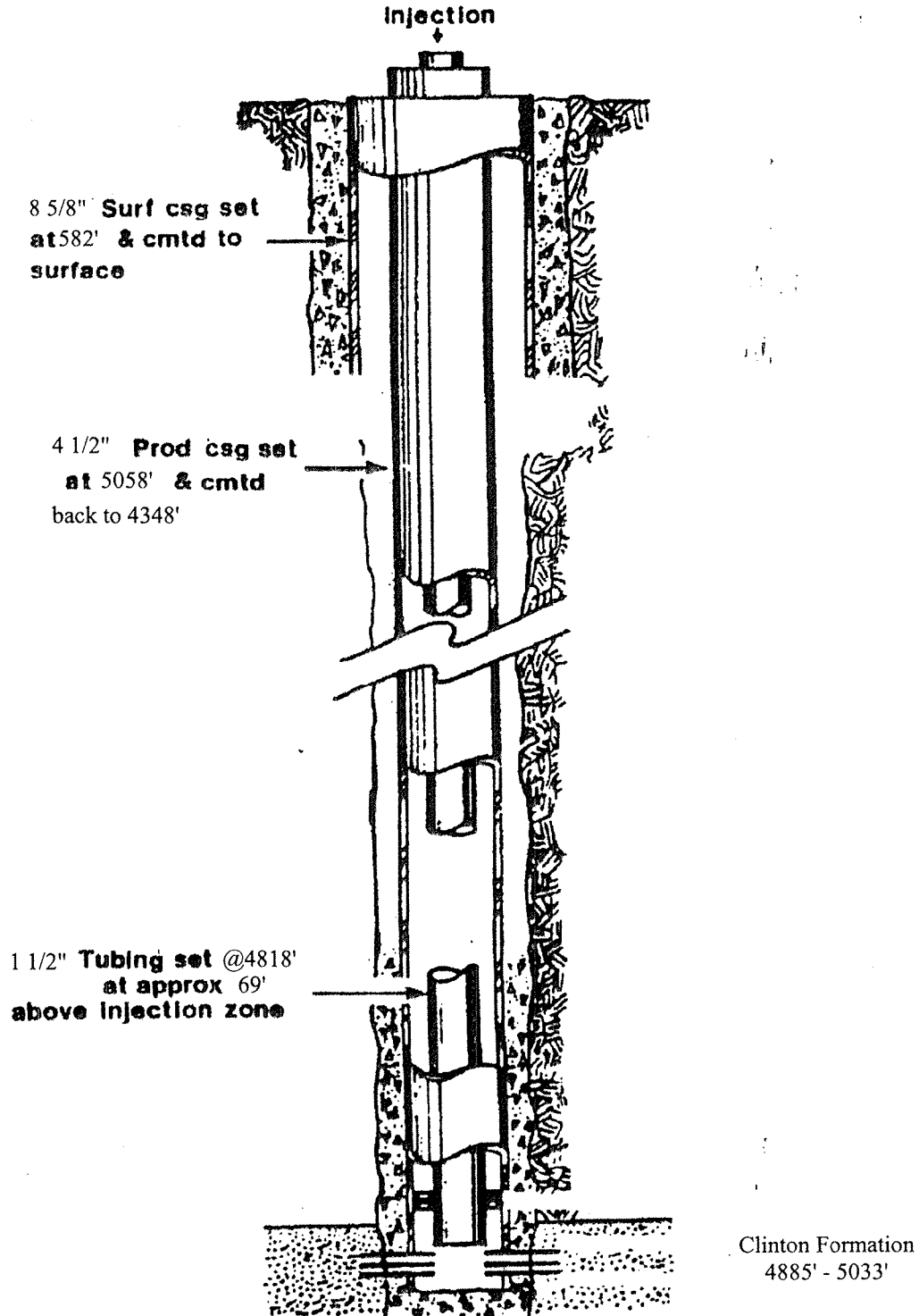

Total Depth: 5101'

RESTORATION PLAN (Form 4)

Ohio Department of Natural Resources

Division of Mineral Resources Management, 2045 Morse Road, Bldg. H-3, Columbus OH 43229-6693

<p>1. DATE OF APPLICATION:</p>	<p>3. API #:</p>
<p>2. OWNER NAME, ADDRESS, & TELEPHONE NO.:</p> <p align="center">KLEESE DEVELOPMENT ASSOC. 103 West Market St. Third Floor Warren, OH 44481</p>	<p>4. WELL #: <u>5</u></p> <p>5. LEASE NAME: <u>KLEESE</u></p> <p>6. PROPERTY OWNER: <u>KLEESE</u></p> <p>7. COUNTY: <u>TRENTON</u></p> <p>8. CIVIL TOWNSHIP: <u>VIRGINIA</u></p> <p>9. SECTION: <u>10</u> 10. LOT:</p>
<p>11. CURRENT LAND USE:</p> <p><input checked="" type="checkbox"/> Cropland <input type="checkbox"/> Commercial</p> <p><input type="checkbox"/> Pasture <input type="checkbox"/> Idle Land</p> <p><input type="checkbox"/> Wetlands <input type="checkbox"/> Recreational</p> <p><input type="checkbox"/> Residential <input type="checkbox"/> Industrial</p> <p><input type="checkbox"/> Unreclaimed strip mine</p> <p><input type="checkbox"/> Woodland: <input type="checkbox"/> Broadleaf <input type="checkbox"/> Needlelike</p>	<p>17. TYPE OF WELL:</p> <p align="center"><input type="checkbox"/> Oil <input type="checkbox"/> Gas <input checked="" type="checkbox"/> Other</p> <p>18. STEEPEST SLOPE GRADIENT CROSSING SITE:</p> <p><input type="checkbox"/> 0 to 2% <input checked="" type="checkbox"/> 2.1 to 8%</p> <p><input type="checkbox"/> 8.1 to 10%</p> <p><input type="checkbox"/> 10.1 to 24% <input type="checkbox"/> greater than 24%</p>
<p>12. SLOPE GRADIENT & LENGTH DETERMINED FROM:</p> <p><input type="checkbox"/> Ground Measurement</p> <p><input checked="" type="checkbox"/> U.S. Geological Survey Topographical Maps</p> <p><input type="checkbox"/> Other: (explain) _____</p>	<p>19. LENGTH OF STEEPEST SLOPE CROSSING SITE:</p> <p><input checked="" type="checkbox"/> 1 to 100 ft. <input type="checkbox"/> 101 to 200 ft.</p> <p><input type="checkbox"/> 201 to 400 ft. <input type="checkbox"/> greater than 400 ft.</p>
<p>13. TYPE OF FALL VEGETAL COVER:</p> <p><input type="checkbox"/> Little or no vegetal cover</p> <p><input type="checkbox"/> Short grasses</p> <p><input type="checkbox"/> Tall weeds or short brush (1 to 2 ft.)</p> <p><input type="checkbox"/> Brush or bushes (2 to 6 ft.)</p> <p><input checked="" type="checkbox"/> Agricultural crops</p> <p><input type="checkbox"/> Trees with sparse low brush</p> <p><input type="checkbox"/> Trees with dense low brush</p>	<p>20. RESTORATION OF DRILLING PITS: **</p> <p><input checked="" type="checkbox"/> Haul drilling fluids and fill pits</p> <p><input type="checkbox"/> Use steel circulating tanks</p> <p><input type="checkbox"/> Proposed alternative _____</p>
<p>14. SOIL & RESOILING MATERIAL AT WELLSITE:</p> <p><input checked="" type="checkbox"/> Stockpile and protect topsoil to be used when preparing seedbed</p> <p><input type="checkbox"/> Use of soil additives (e.g., lime, fertilizer)</p> <p><input type="checkbox"/> No resoiling planned</p> <p><input type="checkbox"/> Proposed alternative _____</p>	<p>21. BACKFILLING AND GRADING AT SITE:</p> <p><input checked="" type="checkbox"/> Construct diversions channeled to naturally established drainage systems</p> <p><input type="checkbox"/> Construct terraces across slopes</p> <p><input type="checkbox"/> Grade to approximate original contour</p> <p><input type="checkbox"/> Grade to minimize erosion & control offsite runoff</p> <p><input type="checkbox"/> Proposed alternative _____</p>
<p>15. DISPOSAL PLAN FOR TREES AND TREE STUMPS:</p> <p><input checked="" type="checkbox"/> No trees disturbed <input type="checkbox"/> Haul to landfill</p> <p><input type="checkbox"/> Cut into firewood <input type="checkbox"/> Sell to lumber</p> <p><input type="checkbox"/> Bury with landowner's approval company</p> <p><input type="checkbox"/> Mulch small trees and branches, erosion control</p> <p><input type="checkbox"/> Use for wildlife habitat with landowner approval</p> <p><input type="checkbox"/> Proposed alternative _____</p>	<p>22. VEGETATIVE COVER TO BE ESTABLISHED AT SITE:</p> <p><input checked="" type="checkbox"/> Seeding plan <input type="checkbox"/> Sod</p> <p><input type="checkbox"/> Agricultural crops <input type="checkbox"/> Trees and/or Bushes</p> <p><input type="checkbox"/> Proposed alternative _____</p>
<p>16. SURFACE AND SUBSURFACE DRAINAGE FACILITIES:</p> <p><input checked="" type="checkbox"/> No existing drainage facilities for removal of surface and/or subsurface water</p> <p><input type="checkbox"/> Tile drainage system underlying land to be disturbed</p> <p><input type="checkbox"/> Drain pipe(s) underlying land to be disturbed</p> <p><input type="checkbox"/> Surface drainage facilities on land to be disturbed</p>	<p>23. ADDITIONAL HOLES:</p> <p><input type="checkbox"/> Rat/Mouse, if used, will be plugged</p> <p>24. PROPOSED OR CURRENT LENGTH OF ACCESS ROAD:</p> <p><input type="checkbox"/> 100 ft. or less <input checked="" type="checkbox"/> 101 to 500 ft.</p> <p><input type="checkbox"/> 501 to 1500 ft. <input type="checkbox"/> greater than 1500 ft.</p>
<p>16. SURFACE AND SUBSURFACE DRAINAGE FACILITIES:</p> <p><input checked="" type="checkbox"/> No existing drainage facilities for removal of surface and/or subsurface water</p> <p><input type="checkbox"/> Tile drainage system underlying land to be disturbed</p> <p><input type="checkbox"/> Drain pipe(s) underlying land to be disturbed</p> <p><input type="checkbox"/> Surface drainage facilities on land to be disturbed</p>	<p>25. CURRENT LAND USE OF PATH OF ACCESS ROAD:</p> <p><input type="checkbox"/> Cropland <input type="checkbox"/> Pasture <input checked="" type="checkbox"/> Commercial</p> <p><input type="checkbox"/> Idle land <input type="checkbox"/> Wetlands <input type="checkbox"/> Recreational</p> <p><input type="checkbox"/> Industrial <input type="checkbox"/> Residential</p> <p><input type="checkbox"/> Unreclaimed strip mine</p> <p><input type="checkbox"/> Woodland: <input type="checkbox"/> Broadleaf <input type="checkbox"/> Needlelike</p>

****PITS MUST BE FILLED WITHIN TWO MONTHS AFTER COMMENCEMENT OF THE WELL AND WITHIN FOURTEEN DAYS AFTER COMMENCEMENT OF THE WELL IN AN URBANIZED AREA.**

REQUIRED BY SECTION 1509.06 (A)(10), OHIO REVISED CODE -- FAILED TO SUBMIT MAY RESULT IN AN ASSESSMENT OF CRIMINAL FINES NOT LESS THAN \$100.00 NOR MORE THAN \$2,000.00 OR CIVIL PENALTIES NOT LESS THAN \$4,000.00.

RECORDED

JUL 13 2012

OHIO EMERGENCY OIL AND GAS WELL LOCATOR MAP

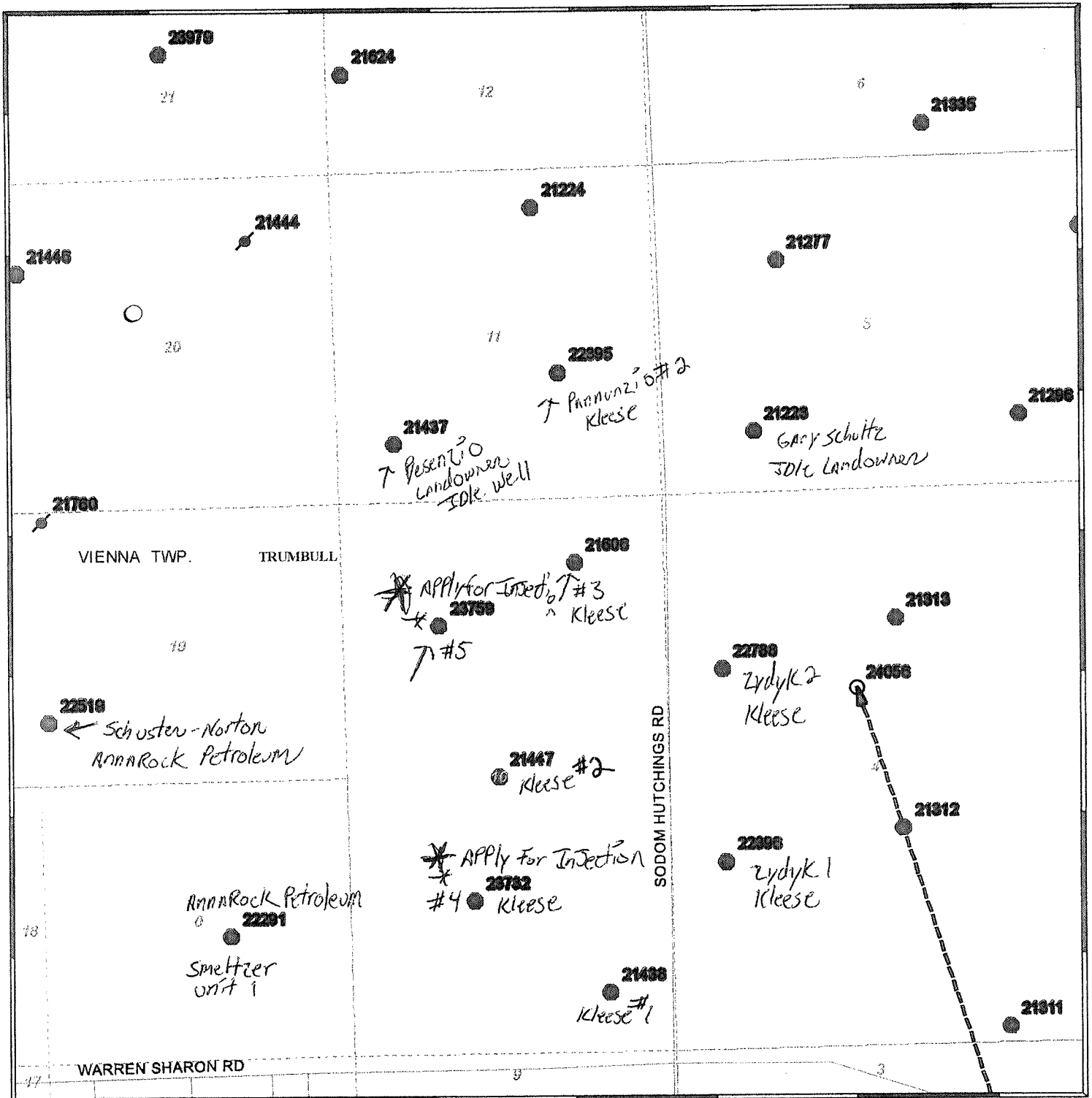

RECEIVED

JUL 03 2012

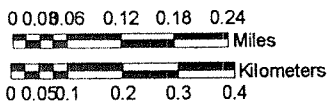

Map provided by:
 The Ohio Department of Natural Resources:
 Division of Geological Survey
 and
 Division of Mineral Resources Management
<http://www.ohiodnr.com/>

INDEX MAP

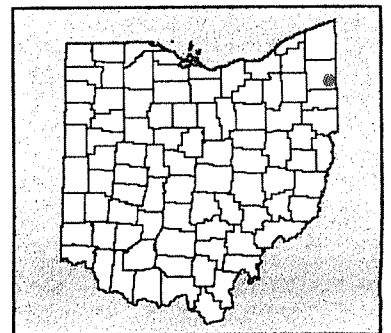

DISCLAIMER

This product of the Ohio Department of Natural Resources, Division of Geological Survey is intended to provide general information only and should not be used for any other purposes. It is not intended for resale or to replace site-specific investigations. These data were compiled by the Ohio Division of Geological Survey, which reserves the publication rights to this material. If these data are used in the compilation of other data sets or maps for distribution or publication, this source must be referenced.

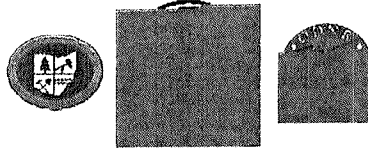

OHIO EMERGENCY OIL AND GAS WELL LOCATOR MAP

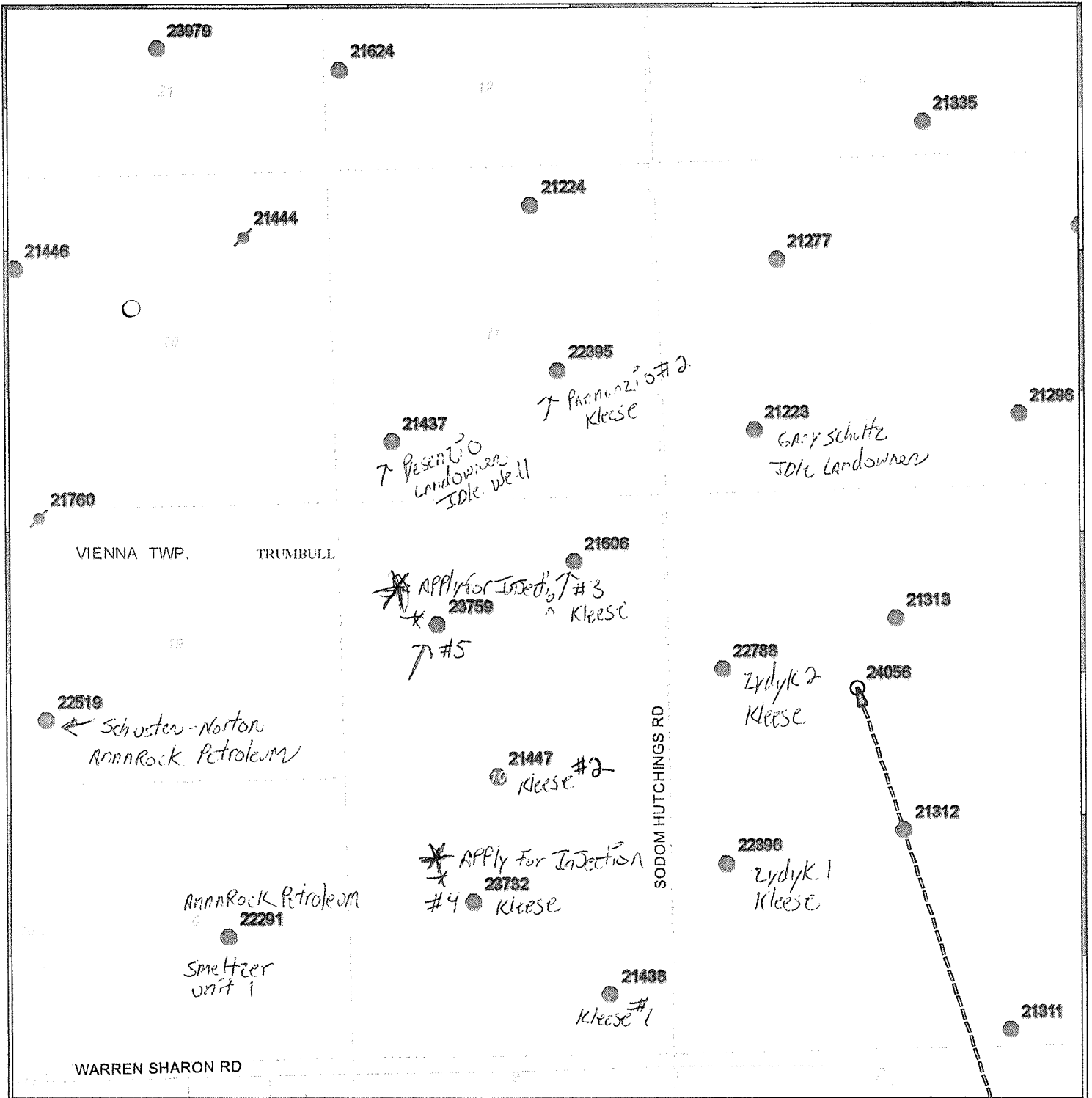

RECEIVED

JUL 03 2012

Map provided by:
 The Ohio Department of Natural Resources:
 Division of Geological Survey
 and
 Division of Mineral Resources Management
<http://www.ohiodnr.com/>

INDEX MAP

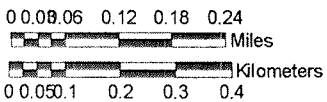

DISCLAIMER

This product of the Ohio Department of Natural Resources, Division of Geological Survey is intended to provide general information only and should not be used for any other purposes. It is not intended for resale or to replace site-specific investigations. These data were compiled by the Ohio Division of Geological Survey, which reserves the publication rights to this material. If these data are used in the compilation of other data sets or maps for distribution or publication, this source must be referenced.

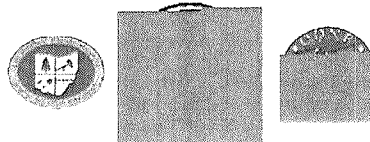

Tomastik, Tom

From: Tulsaruffneck5 [tulsaruffneck5@aol.com]
Sent: Wednesday, May 23, 2012 5:37 PM
To: Tomastik, Tom
Cc: rkleese@aol.com
Subject: Re: KDA 2174: Kleese No. 6 Injection - Update
 Tom

Thank you for your review and we are interested in working on our existing number four. The number 6 was a possible futuristic projection per your review. We are comfortable with your opinion and we will look forward to working with you and your other inspectors in the future with our number four hopefully. Thanks again and have a great evening we will stay in close contact with you as the time progresses.

M.J. KLEESE

-----Original Message-----

From: Tomastik, Tom <Tom.Tomastik@dnr.state.oh.us>
To: Tulsaruffneck5 <tulsaruffneck5@aol.com>
Sent: Tue, May 22, 2012 7:49 am
Subject: RE: KDA 2174: Kleese No. 6 Injection - Update

Matt:

I have conducted the preliminary area of review for the Kleese #4. It is capable of injection into the Clinton sandstone at volumes greater than 200 barrels per day. I would wait on the Kleese #6 well as you may end up with too many wells in close proximity and see well inference which could reduce your injection capacity. I would be in no hurry to submit an application as we still are not issuing any new injection permits yet. I have 20 pending on my desk.

Tom Tomastik, Geologist 4
 Division of Oil and Gas Resources Management
 2045 Morse Road, F-2
 Columbus, Ohio 43229-6693
 (614) 265-1032

From: Tulsaruffneck5 [mailto:tulsaruffneck5@aol.com]
Sent: Tuesday, May 15, 2012 10:32 AM
To: Tomastik, Tom
Subject: Fwd: KDA 2174: Kleese No. 6 Injection - Update

Dear Tom,

This is Mathew Kleese with Kleese Development. I have attached a surveyed overview that includes all of our Kleese wells on our farm. Currently as you know we are injecting into the number 1 and 2 wells and are looking to drill the proposed Kleese number six well to complete to the newburg formation on the plat attached. I also would like you to review the Possibility of us Converting the Kleese number 4 on the attached form as well only to the clinton formation that is existing. I feel our spacing isnt terrible for the number four and that we have already notified the Hawley unit one owner and Annarock Petroleum on our projects previously and havent had any issues to date. Please get back to me and let me know if these look like possibilities for us to start working on. Please feel free to contact me at your earliest convenience at 330-360-8055 or on this email address.

5/24/2012

Thank you,

M.J. KLEESE

-----Original Message-----

From: Jason Holderbaum <Jason@BodoSurveying.com>
To: mjkleese <mjkleese@kleeserdev.com>
Cc: Nick Perod (NPATRIUM@aol.com) <NPATRIUM@aol.com>
Sent: Thu, May 3, 2012 2:40 pm
Subject: KDA 2174: Kleese No. 6 Injection - Update

Matt,

Attached is the updated preliminary overview of KDA 2174: Kleese No. 6 Injection per our conversation. As I was working through this overview I was able to come up with two different options to place a location. The biggest issues for the one to the north would be the parcels within 500' as well as the buildings on both the James Kleese parcel as well as the Kenneth & Julie Barr parcel. They both look to be aprox 500' or closer. The Option "A" to the south is closer to the other injection site but there are no buildings that I can see on our air photo within 500' unless something has been built in the last year or two. Please advise how to proceed.

Jason Holderbaum
David Bodo & Associates, Inc.
Professional Surveyors
5175 Tongo Road NW
Carrollton, Ohio 44615
(330) 863-2300
Jason@BodoSurveying.com
www.BodoSurveying.com

5/24/2012

Tomastik, Tom

From: Tomastik, Tom
Sent: Tuesday, May 22, 2012 7:50 AM
To: 'Tulsaruffneck5'
Subject: RE: KDA 2174: Kleese No. 6 Injection - Update
Matt:

I have conducted the preliminary area of review for the Kleese #4. It is capable of injection into the Clinton sandstone at volumes greater than 200 barrels per day. I would wait on the Kleese #6 well as you may end up with too many wells in close proximity and see well inference which could reduce your injection capacity. I would be in no hurry to submit an application as we still are not issuing any new injection permits yet. I have 20 pending on my desk.

Tom Tomastik, Geologist 4

Division of Oil and Gas Resources Management

2045 Morse Road, F-2

Columbus, Ohio 43229-6693

(614) 265-1032

From: Tulsaruffneck5 [mailto:tulsaruffneck5@aol.com]
Sent: Tuesday, May 15, 2012 10:32 AM
To: Tomastik, Tom
Subject: Fwd: KDA 2174: Kleese No. 6 Injection - Update

Dear Tom,

This is Mathew Kleese with Kleese Development. I have attached a surveyed overview that includes all of our Kleese wells on our farm. Currently as you know we are injecting into the number 1 and 2 wells and are looking to drill the proposed Kleese number six well to complete to the newburg formation on the plat attached. I also would like you to review the Possibility of us Converting the Kleese number 4 on the attached form as well only to the clinton formation that is existing. I feel our spacing isnt terrible for the number four and that we have already notified the Hawley unit one owner and Annarock Petroleum on our projects previously and havent had any issues to date. Please get back to me and let me know if these look like possibilities for us to start working on. Please feel free to contact me at your earliest convenience at 330-360-8055 or on this email address.

Thank you,

M.J. KLEESE

-----Original Message-----

From: Jason Holderbaum <Jason@BodoSurveying.com>

5/22/2012

To: mjkleese <mjkleese@kleesedev.com>
Cc: Nick Perod (NPATRIUM@aol.com) <NPATRIUM@aol.com>
Sent: Thu, May 3, 2012 2:40 pm
Subject: KDA 2174: Kleese No. 6 Injection - Update

Matt,

Attached is the updated preliminary overview of KDA 2174: Kleese No. 6 Injection per our conversation. As I was working through this overview I was able to come up with two different options to place a location. The biggest issues for the one to the north would be the parcels within 500' as well as the buildings on both the James Kleese parcel as well as the Kenneth & Julie Barr parcel. They both look to be approx 500' or closer. The Option "A" to the south is closer to the other injection site but there are no buildings that I can see on our air photo within 500' unless something has been built in the last year or two. Please advise how to proceed.

Jason Holderbaum
David Bodo & Associates, Inc.
Professional Surveyors
5175 Tongo Road NW
Carrollton, Ohio 44615
(330) 863-2300
Jason@BodoSurveying.com
www.BodoSurveying.com

5/22/2012

Tomastik, Tom

From: Tulsaruffneck5 [tulsaruffneck5@aol.com]
Sent: Tuesday, May 15, 2012 10:32 AM
To: Tomastik, Tom
Subject: Fwd: KDA 2174: Kleese No. 6 Injection - Update
Attachments: Kleese_No_6_-_Injection_Preliminary_Overview_18_x_18.pdf

Dear Tom,

This is Mathew Kleese with Kleese Development. I have attached a surveyed overview that includes all of our Kleese wells on our farm. Currently as you know we are injecting into the number 1 and 2 wells and are looking to drill the proposed Kleese number six well to complete to the newburg formation on the plat attached. I also would like you to review the Possibility of us Converting the Kleese number 4 on the attached form as well only to the clinton formation that is existing. I feel our spacing isnt terrible for the number four and that we have already notified the Hawley unit one owner and Annarock Petroleum on our projects previously and havent had any issues to date. Please get back to me and let me know if these look like possibilities for us to start working on. Please feel free to contact me at your earliest convenience at 330-360-8055 or on this email address.

Thank you,

M.J. KLEESE

-----Original Message-----

From: Jason Holderbaum <Jason@BodoSurveying.com>
 To: mjkleese <mjkleese@kleesedev.com>
 Cc: Nick Perod (NPATRIUM@aol.com) <NPATRIUM@aol.com>
 Sent: Thu, May 3, 2012 2:40 pm
 Subject: KDA 2174: Kleese No. 6 Injection - Update

Matt,

Attached is the updated preliminary overview of KDA 2174: Kleese No. 6 Injection per our conversation. As I was working through this overview I was able to come up with two different options to place a location. The biggest issues for the one to the north would be the parcels within 500' as well as the buildings on both the James Kleese parcel as well as the Kenneth & Julie Barr parcel. They both look to be aprox 500' or closer. The Option "A" to the south is closer to the other injection site but there are no buildings that I can see on our air photo within 500' unless something has been built in the last year or two. Please advise how to proceed.

Jason Holderbaum
 David Bodo & Associates, Inc.
 Professional Surveyors
 5175 Tongo Road NW
 Carrollton, Ohio 44615
 (330) 863-2300
Jason@BodoSurveying.com
www.BodoSurveying.com

5/15/2012

Tomastik, Tom

From: Tomastik, Tom
Sent: Monday, May 16, 2011 11:52 AM
To: 'Tulsaruffneck5@aol.com'
Subject: RE: M.J. Kleese- Kleese Development Associates Kleese #'s 1,2&3 permit for injection

MJ:

I am working on the area of reviews for the three wells listed below. I need the 4-1/2" production casing cementing records for Permit #1437 and Permit #1438 to complete the three reviews. Additionally, if after receiving this information and you proceed with wanting to convert all three of these existing Clinton wells to saltwater injection, you will be required to run cement bond logs on all three wells to demonstrate 300 feet of cement above the proposed injection zones in the Newburg (this can be a requirement of the permit and can be done after the permits have been issued). If inadequate cement exists, then you may have to do remedial cementing (I will need to see the cement bond logs first, as I can issue a variance if there is less than 300 feet of cement with 80% or better bond).

Thanks,
 Tom Tomastik, Geologist 4
 Division of Mineral Resources Management
 2045 Morse Road, H-3
 Columbus, Ohio 43229-6693
 (614) 265-1032

From: Tulsaruffneck5@aol.com [mailto:Tulsaruffneck5@aol.com]
Sent: Friday, May 06, 2011 6:07 PM
To: Tomastik, Tom
Subject: M.J. Kleese- Kleese Development Associates Kleese #'s 1,2&3 permit for injection

Howdy Tom,

It was a pleasure speaking with you today regarding the injection well process and the wells below That are in interest to convert into injection wells by Kleese Development Associates. I was very happy to talk with you regarding the particulate issues with the P.A. flow back and obtained a lot of useful information I will be able to use while hopefully pursuing these disposal wells so thank you for your time and for sharing your knowledge. Below you will find information put together by Tom Wood, our petroleum engineer and acting Geologist. If there are any questions please feel free to contact me at any time at 330-360-8055 or by email at this address. Thank you again for your courtesy and professionalism in this matter.

M.J. Kleese
 Oil and Gas Division Supervisor

M.A. KLEESE #1
 #1438
 Township-Vienna
 County-Trumbull
 State- Ohio
 Well activity- currently active producer
 Formation completed-Clinton
 Formation of interest-Newburg
 Depth- 4570-4620

5/16/2011

M.A. KLEESE #2
#1447
Township- Vienna
County- Trumbull
State- Ohio
Well activity- currently active producer
Formation completed- Clinton
Formation of interest- Newburg
Depth- 4604-4670

Kleese #3
#1606
Township- Vienna
County- Trumbull
State- Ohio
Well activity- currently active producer
Formation completed- Clinton
Formation of interest- Newburg
Depth- 4532-4592

5/16/2011

Tomastik, Tom

From: Tulsaruffneck5@aol.com
Sent: Friday, May 06, 2011 6:07 PM
To: Tomastik, Tom
Subject: M.J. Kleese- Kleese Development Associates Kleese #'s 1,2&3 permit for injection

Howdy Tom,

It was a pleasure speaking with you today regarding the injection well process and the wells below that are in interest to convert into injection wells by Kleese Development Associates. I was very happy to talk with you regarding the particulate issues with the P.A. flow back and obtained a lot of useful information I will be able to use while hopefully pursuing these disposal wells so thank you for your time and for sharing your knowledge. Below you will find information put together by Tom Wood, our petroleum engineer and acting Geologist. If there are any questions please feel free to contact me at any time at 330-360-8055 or by email at this address. Thank you again for your courtesy and professionalism in this matter.

M.J. Kleese
Oil and Gas Division Supervisor

M.A. KLEESE #1
#1438
Township-Vienna
County-Trumbull
State- Ohio
Well activity- currently active producer
Formation completed-Clinton
Formation of interest-Newburg
Depth- 4570-4620

M.A. KLEESE #2
#1447
Township- Vienna
County- Trumbull
State- Ohio
Well activity- currently active producer
Formation completed- Clinton
Formation of interest- Newburg
Depth- 4604-4670

Kleese #3
#1606
Township- Vienna
County- Trumbull
State- Ohio
Well activity- currently active producer
Formation completed- Clinton
Formation of interest- Newburg
Depth- 4532-4592

5/9/2011

FAX

FROM: KLEESE DEVELOPMENT
103 WEST MARKET
WARREN, OH 44481
330-392-7899
330-392-9022 FAX

TO: Tom
From: MJ Kleese
DATE: 5/17/2011

PAGES TO FOLLOW: 3

Guard Log MAZ

RECEIVED
MAY 17 2011
MINERAL
RESOURCES MANAGEMENT



PERFECTION SERVICES INC.

STONE CREEK, OHIO 43840

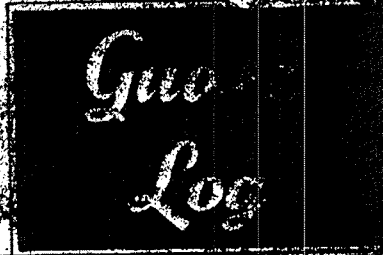

FILING NO. Permit # 1438		COMPANY <u>Geosearch, Inc.</u>	
		WELL <u>M.A. Kleese #1</u>	
		FIELD <u>North Vienna</u>	
		COUNTY <u>Trumbull</u>	STATE <u>Ohio</u>
		LOCATION: <u>505'SL + 505'EL</u>	OTHER SERVICES: Comp. Den. Neutron Log + 2 in. Scale
Field Print	Twp. <u>10</u>	Twp. <u>Vienna</u>	RGE
PERMANENT DATUM: <u>Ground Level, ELEV. 1184</u>		ELEV.: K.B. <u>1196'</u>	
LOG MEASURED FROM <u>DF 10</u> FT. ABOVE PERM. DATUM		D.F. <u>1194'</u>	
DRILLING MEASURED FROM <u>KB 12</u>		G.L. <u>1184'</u>	
DATE	<u>3-17-80</u>		
RUN NO.	<u>010</u>		
TYPE LOG	<u>Guard</u>		
DEPTH—DRILLER	<u>5147'</u>		
DEPTH—LOGGER	<u>5156'</u>		
BOTTOM LOGGED INTERVAL	<u>5152'</u>		
TOP LOGGED INTERVAL	<u>3100'</u>		
TYPE FLUID IN HOLE	<u>Water</u>		
CL.	<u>ng</u>		
VISCOSITY	<u>na ng</u>		
LEVEL	<u>2000'</u>		
MAX. RES. TEMP., DEG. F.	<u>ng</u>		
SOURCE OF SAMPLE	<u>P17</u>		
Rm @ MEAS. TEMP.	@	°F	@ °F
Rmf @ MEAS. TEMP.	@	°F	@ °F
Rmc @ MEAS. TEMP.	@	°F	@ °F
TIME SINCE CIRC.			
CASING—DRILLER	<u>8 7/8"</u>	@ <u>527° F</u>	@ °F
CASING—LOGGER	<u>8 7/8"</u>	<u>534'</u>	
BIT SIZE	<u>7 7/8"</u>		
RECORDED BY	<u>Limbacher</u>		
WITNESSED BY	<u>Mr. Frysinger</u>		

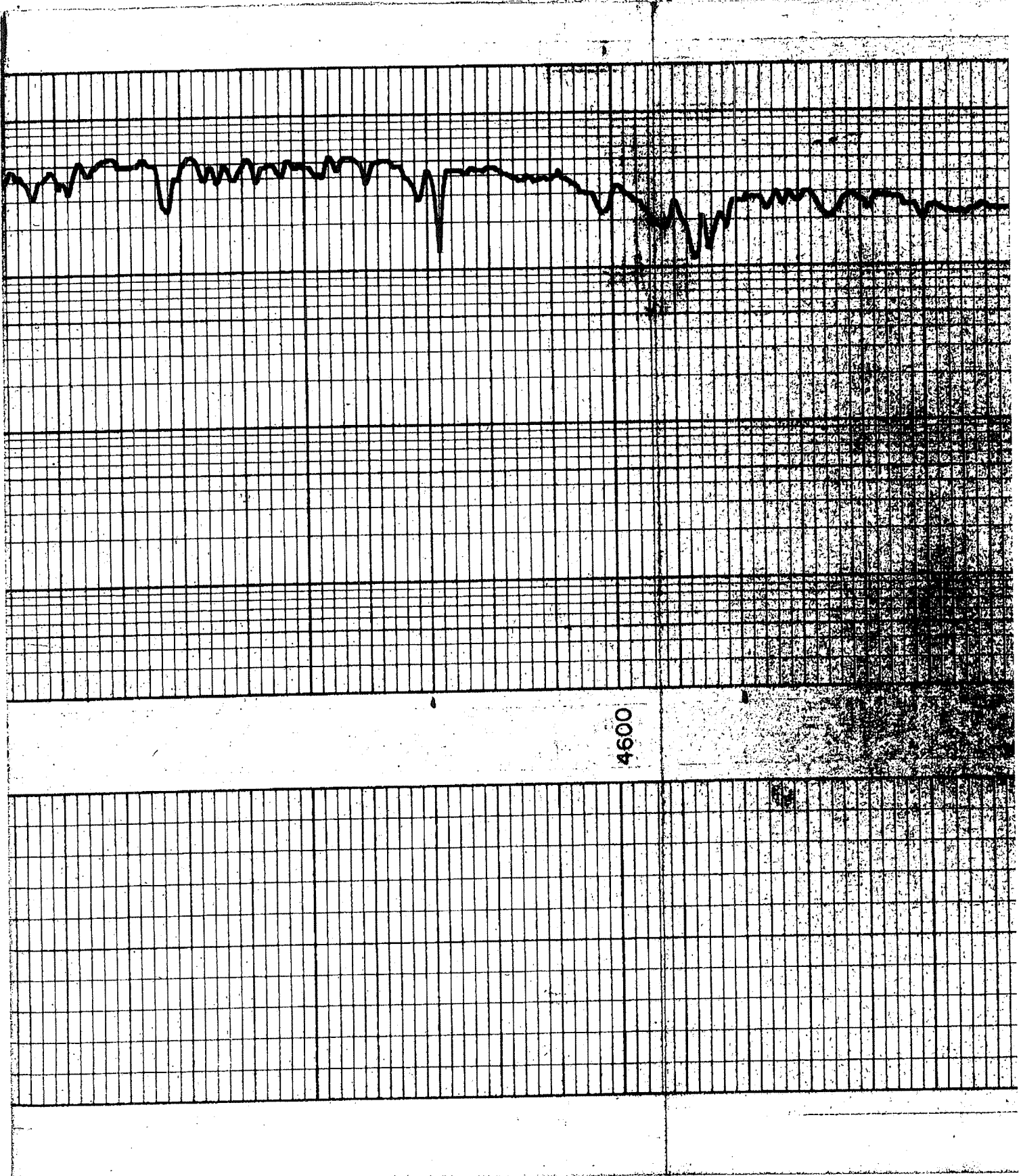



4400

4500

